

FIRM FOR THE **FOUNDATION** FUTURE



No one can
lay any
foundation
other than
the one
already laid,
which is
Jesus Christ.

1 Corinthians 3.11

Providence Friends,

Early on a cold Sunday morning in late March, eighteen years ago, I preached my first sermon for a brand new church. The sermon was not memorable, but the morning I will never forget. 144 people ventured out and gathered under a pavilion at Mundy Park. We prayed and sang and shared bread and juice as we celebrated a Risen Savior. It was Easter 2008, the first ever gathering of Providence Church.

What drew those first followers together was the vision we shared—to see those who feel disconnected from God and the church find hope, healing, and wholeness in Jesus Christ. Since then, that vision has drawn more and more people to Providence. In 2016, we built our beautiful church home on top of a hill on S. Rutland Road. Today, thousands of people call Providence Church home as God has deepened our purpose to see more people become disciples of Jesus and grow deeper with Him.

We have outgrown our building! Even with multiple services and the use of every room in the building, we are overflowing, not just on Sunday mornings but throughout the week.

We believe now is the time to take another big step in the life of Providence Church. Remembering that our firm foundation is Jesus Christ, we know it is time to build again.

I am asking you to pray with me a simple prayer over the next few weeks. **God, what do You want to do through me for Your people?** This campaign is all about God and all about people.

We have the opportunity to be a part of a historic moment in the life of our church. It will impact generations to come. For that to happen, each of us will have to prayerfully consider how God is calling us to be generous and sacrificial to expand His church for His people.

I am inviting you to join Rachel and me in praying about what God can do through us in this capital campaign. I am excited to see what God does next!

JACOB

Pastor Jacob Armstrong



**"God, what do You
want to do through me
for Your people?"**



Dear Fellow Members and Friends of Providence Church,

We appreciate you taking the time to consider and pray about the expansion of Providence Church. We have a real opportunity to make a difference in the world.

If you're like us, you've probably attended Providence recently and found someone in "your" seat. That is always a surprise, but it is also a blessing. The real problem, of course, is when someone who hasn't attended church in years, if ever, comes for a visit and finds there is no seat for them.

If you're like us, there is someone close to you that you wish was attending church but isn't. Let's each keep praying that will happen for them, wherever they may be. No doubt for many people, the loved one they pray for is right here in Wilson County. Let's make room for them at Providence and expand our building in honor of our own loved ones who need a place.

Once they find a seat, we believe their lives will be changed. At Providence, that looks like serving others, giving generously to support the important mission of the church, and inviting others to find a seat and have their own lives changed. To do that, we need more room. It is an urgent need. Please join us in praying our campaign prayer, **God, what do You want to do through me for Your people?** as you consider what you can pledge and give over the next three years.

Raymond & Mimi Hurd

Raymond & Mimi Hurd
Campaign Co-Chairs



MAKING ROOM FOR More & Deeper Disciples at Providence Church

Total Site: 23.74 Acres

Original Construction (2016):

Interior: 28,632 sf
Worship Center: 750 seats (originally)
Currently: 820 seats
ProvKIDS classrooms: 10

Existing parking spaces: 295
New parking spaces: 406
Total parking spaces: 701

Proposed Expansion (2026):

New Worship Center: 28,830 sf
1600 seats (including balcony)
New lobby: 11,082 sf
ProvKIDS addition: 9,015 sf
Expanded ProvKIDS lobby and check-in
20 total classrooms
Total Expansion: 48,927 sf

LEGEND:

- New Worship Center & gathering space
- New Prov KIDS classrooms & lobby
- New Parking
- Current Church footprint

THE Current Reality

In 2018 and 2019, Providence was recognized as one of the fastest-growing churches in the nation. After the pandemic, that growth trend continued.

Average weekly attendance

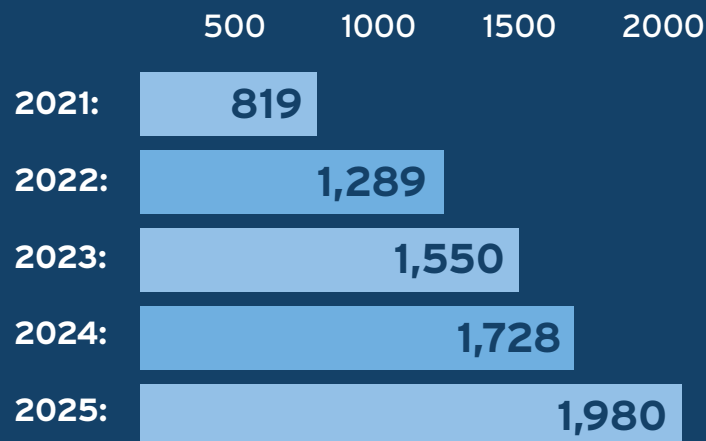

With growth, there have been challenges. Our 800-seat worship center struggles to accommodate the number of people who attend each week, particularly at the 9:30 service. On a typical Sunday morning, every parking spot is occupied, and an additional 40 to 50 vehicles are parked in the driveway and on the grass. Lines of cars stretch in both directions on S. Rutland Road as families wait to enter the parking lot. We have seen families pull into the lot, circle around, and drive away because they couldn't find a parking space.

The ProvKIDS hallway is also over capacity, with more than 230 children crowded into 10 classrooms. As with the parking lot, we've seen families with young children enter the ProvKIDS lobby, see the crowded hallway and classrooms, and then turn around and leave. The size of the ProvKIDS wing has limited the growth of our ProvKIDS ministry. Since 2022, overall worship attendance at Providence has increased by 54%, but ProvKIDS attendance has stayed roughly the same.

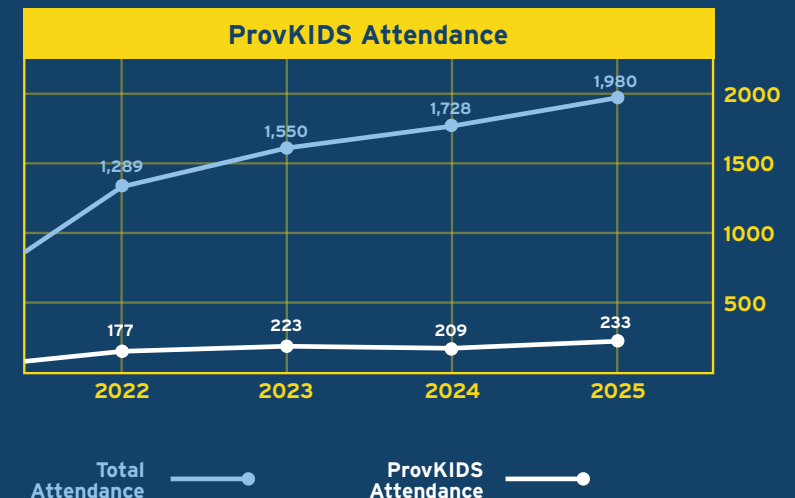

OUR VISION

To see those who feel disconnected from God and the church find hope, healing, and wholeness in Jesus Christ

OUR Direction

In 2024, Providence Church paid off the original mortgage on our facility, becoming debt-free! We now need to expand to better meet current needs, support ongoing growth, and make more and deeper disciples now and in the future. Here's what that looks like:

1 Build a larger Worship Center.

Most people connect with Jesus at Providence on Sunday mornings. We plan to build a **1,600-seat worship center** that will allow twice as many people to connect with Jesus, have their lives changed, and start on the pathway to becoming deeper disciples of Jesus. A larger worship center will also allow us to reduce the number of weekly services from three to two, encouraging church members to connect with each other and creating a more sustainable pace over the long term for our pastors and staff.

2 Double the size of the ProvKIDS wing.

Teaching our children that Jesus loves them and desires a relationship with them is perhaps the most important thing we do. Currently, we lack enough space to do that. We plan to **expand the ProvKIDS wing from 10 to 20 classrooms** and add more lobby and hallway space.

3 Create more parking spaces.

As the size of the worship center grows, our parking needs will also grow. We plan to **expand our parking lot from 300 to 700 spaces**. This will help us address the current parking shortage, provide more visitor parking, and create more parking closer to the building for those who need assistance accessing it.

This proposed plan will benefit all the ministries of our church. A new larger Worship Center and lobby will allow our existing Worship Center to become a multipurpose space used by our Student ministry, Adult discipleship (Practicing the Way, large-group Bible studies), ProvKIDS worship, Vacation Bible School, and more!

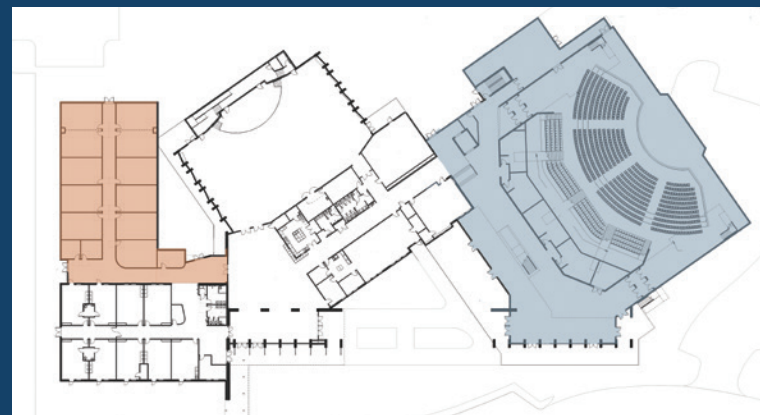

COST Projections

In 2024, following a 7-month study of the needs of the church, the Providence Church board of directors, or “Church Council,” determined that a lack of space was hindering the church from fully fulfilling its vision and mission. The Council selected a Building Committee to work with an architect and contractor to develop preliminary architectural drawings and cost estimates for a possible building expansion. Here are the initial figures for each construction focus area:

\$13.1M - \$13.4M	Larger Worship Center (1,600 seats) and lobby space
\$3.4M - \$3.7M	Expanded ProvKIDS wing
\$3.1M - \$3.4M	Additional parking and sitework
approx. \$5.0M	Soft costs (furniture, fixtures, equipment, fees, etc.)
\$24.6M - \$25.5M	Preliminary Estimate

OUR MISSION

To make more, and deeper disciples of Jesus



OUR VISION
TO SEE THOSE WHO FEEL DISCONNECTED
FROM GOD AND THE CHURCH FIND
hope, healing, and
wholeness
IN JESUS CHRIST

NEXT Steps

Here are the steps our church already has taken:

1. Assessed our current facility and ministry needs
2. Selected a Building Committee to hire an architect and contractor
3. Developed preliminary architectural drawings and cost estimates
4. Conducted a church-wide survey to assess the church's readiness to move forward

Here are the next steps for us to move forward:

1. Conduct a successful capital campaign
2. Approve, by a vote of the Church Council, the plans for the expansion
3. Approve, by a vote of all covenant members of Providence Church, the plans for the expansion
4. Begin construction in late 2026 or early 2027

Upcoming Campaign Events:

February 22 - Celebration Sunday

March 1 - Commitment Sunday

March 22 - Announcement Sunday

March 22 to April 19 - First Fruits Offering

STRATEGIES for Generosity

In addition to traditional methods of financial support, you may wish to donate to the Firm Foundation campaign by providing a non-cash gift.

What is a non-cash gift?

Transferring ownership of an asset, rather than selling the asset and donating the proceeds, is one kind of non-cash gift. Appreciated investment property held more than one year, such as publicly traded stocks, mutual fund shares, and bonds, may be donated.

Why give a non-cash gift?

The tax code favorably treats non-cash gifts. Giving a non-cash asset to Providence may not generate capital gains tax liability for the donor. And as the gift beneficiary, Providence will realize the full market value of the non-cash asset at the time of transfer and not incur capital gains tax liability.

How do I make a non-cash gift?

1. Contact **Dan Lins**, who will provide you with transfer instructions
2. Contact your broker and request a transfer

Can I make a non-cash gift from an IRA?

Traditional IRA: If you are 70.5 years old or older, you can donate to Providence up to \$11,000 for tax year 2026 as a qualified charitable distribution (QCD) without penalty or tax liability. A gift from a traditional IRA can assist in satisfying a required minimum distribution (RMD) requirement and may lower your overall tax liability.

QCDs can be a great tool for managing taxable income in retirement while also supporting this campaign. Please be aware that QCDs are not permitted from 401(k)s or other qualified plans.

NOTE: Any discussion of tax treatment is not intended as and should not be considered tax advice. For personal tax advice, consult a professional tax advisor.

FREQUENTLY Asked Questions

How much are we trying to raise?

An outside feasibility study conducted between July and December 2025 concluded that Providence can raise between \$9 million and \$11 million or more, over and above regular giving, over three years. A successful campaign at or above that range will allow us to proceed with the expansion as planned on our current timetable. Every pledge exceeding that goal will (first off, be celebrated as a miracle!) help reduce our ultimate costs by reducing loan amounts and interest.

When will the work begin, and when will it be completed?

We hope to begin construction in late 2026 or early 2027. Construction is estimated to last 18 months.

Can we use our current space during construction?

Yes. One of the reasons we selected T.W. Frierson as our contractor is their experience staging and phasing large construction projects for churches in a way that allows the church's weekly worship and activities to continue during construction.

How will we handle continued growth in the meantime?

Given our current worship space and parking limitations, our most likely avenue for accommodating present and future growth would be to add an additional weekly worship service. Adding a fourth service is not a sustainable long-term solution, however, it is a workable short-term option, particularly with an end date in sight!

Is this expansion big enough?

After more than a year of prayerful study and consideration, including two seasons of intentional prayer, our leadership believes this is the right size expansion for our church at this time. It allows us to address our most urgent needs, while not overextending the church financially in a way that would compromise mission and ministry.

Is this expansion too big?

Will Providence become a "megachurch" and lose its identity? No. Our focus will always be on Jesus, Jesus, Jesus, and what God is doing in our midst. We are being called to make more and deeper disciples, and that requires more room. One benefit of more room is that it allows us to move from three (or four!) services down to two, which we believe will increase community!

When does the campaign giving period begin and end? Does it matter how long I take to fulfill my pledge?

To provide flexibility and creativity in charitable giving, our three-year giving period is actually a 37-month period spanning four calendar years: March 2026 to March 2029. While you have a three-year window to fulfill your pledge, the church will incur a significant portion of construction costs in 2026-27, so any early gifts received will help reduce our ultimate costs by reducing loan amounts and interest.

What if the campaign does not raise \$9 million to \$11 million?

If our hoped-for fundraising range is not met, our leadership will pause for a season of prayer and discernment. We likely would not proceed with the project on its current timetable, which would result in higher costs down the road as prices increase. However, we know God can be trusted! We believe God has guided our church to this exciting moment, and we believe the people of Providence Church will invest in the future He is preparing for us.



Dear Providence Church Family,

What a remarkable time to be part of Providence Church! Our vision—to see those who feel disconnected from God and the church find hope, healing, and wholeness in Jesus Christ—isn't just a slogan on a page. As longtime members, we have seen it lived out time and time again, including in our own lives.

Providence has always been about people not buildings. Whether it's Worship Without Walls in the early years or giving away a Christmas offering of more than half a million dollars this past December, we are so thankful to be part of a church that is extravagantly generous to people. The church's vision is about disconnected people, its mission is about more people becoming deeper disciples, it's all about people.

And so, as we launch this building campaign, we do so with clear conviction: this is about people, not just expanding our space. A prayerfully curated space for Providence will help us welcome more people and be a place where those people can find belonging, grow in their faith, and serve together with purpose.

We invite you to join us in prayer and discernment. Ask, **God, what do You want to do through me for Your people?** And then consider how God may be leading you to participate in this campaign with a generous and joyful heart. We believe that God will continue to provide for His people, through us, more than we can ask or imagine.

Michael & Melissa Robinson

Michael & Melissa Robinson
Campaign Co-Chairs





providence church



Visit our campaign website!
prov.church/firm-foundation

615.773.7862

2293 S. Rutland Road,
Mt. Juliet, TN 37122